

TECHNICAL CATALOGUE

Current Transformer | Control Transformer



NEWTEK ELECTRICALS

An ISO 9001 : 2008 Certified Company

Transforming | Measuring | Technology

Introduction

Brief History:

The Company was originally started as Wintek Electricals Pvt. Ltd. company as a Joint Venture with a German company in the year 2005. Thus the journey of Wintek Electricals Pvt Ltd began with a blend of technical expertise from Germany and India. With technical collaboration between the two, innovations were introduced which speak for themselves even today. With increasing demand for quality Transformers in the Indian Market, it was the need of the hour to cater to the needs of Indian market which had a large potential which was increasing twofold every month. Accordingly the bold step had to be taken and finally a completely independent company "Newtek Electricals" was formed in the year 2007 with the sole intention of introducing International Standard CTs in the Indian Market.

About Us:

We Newtek Electricals introduce ourselves as manufacturer of Instrument Transformers (CTs, PTs, COTR etc.,) and Digital Meters (VAF, MFM, kWh). Newtek Electricals is an ISO 9001:2008 certified. We are the first one to introduce Nylon Flame Retardant Casing Current Transformers (CTs).

Our product is been used in many prestigious projects in India as well as in other countries. The company has established its reputation within a short period as an innovative leader and quality manufacture by continuously upgrading technology, modernizing and manufacturing facilities and maintaining highest standards of quality and services.

Our Quality Concept:

We are dedicated towards upgrading the quality of Instrument transformers and digital meters. We share your high demands on quality, technical proficiency and services. These demands are an integral part of our company and serves as a constant reminder of tasks that we have taken as our responsibility. Every time we complete a job, we have improved our quality and that is what we are constantly striving to do.

All transformers are thoroughly tested during manufacturing process for any defects so that we can give guarantee to you to receive a quality product. Apart from all these our CTs and Meters are approved by CPRI (Central Power Research Institute, Bhopal) and ERDA (Electrical Research Development Association, Vadodara), respectively.

Our Customers



Our End Customers



BANGLADESH STEEL
RE-ROLLING MILLS



JINDAL STEEL WORKS



VALE SHIPPING HOLDING PTE. LTD.



ACC LIMITED



JBF Petrochemicals Ltd.



Consultants

MECON Limited.

Avant Garde Consultants, Chennai.

Tata Consulting Engineers, India.

Semac Consulting Engineers
Bangalore.

Synergy Infra Consultants Pvt. Ltd.,
Hyderabad.

Knexir, Mumbai.

Entask Consultancy Services

J P Mukherji & Associates, Pune.

SNC Lavin, Mumbai.

AECOM (previously Spectral Services
Consultants Pvt. Ltd.)

Abhiyanta Electricals and
Engineers Consultants, Pune.

Sripeksha Engineering
Consultancy Services Pvt. Ltd.,
Bangalore.

RSP Consulting Engineers, Bangalore.

Neil Soft Consultants, Pune.

S. N. Joshi Consultants, Pune

C.R. Narayan Rao Consultants

Mott MacDonald, Ahmedabad.

ESKAYEM Consultants, Mumbai.

Convenient Construction &
Consultancy Pvt. Ltd., Indore.

Seth techno Consultants,
Ahmedabad.

Unique Consultant Services,
Sangli/Pune.

Powertec Engineering, Chennai

Kausi Consultancy Services

S. R. Associates, Chennai

WSP Consultants India Ltd.

Technip India Ltd.

Excel Design Engineers, Chennai



NEWTEK ELECTRICALS

Projects

Steel Project

1. Kalyani Garuda, Raichur
2. BSRM, Bangladesh
3. Sohar, Oman
4. JSPL, Tamnar
5. Durgapur Steel Plant
6. JSW Steel, Dolvi

Pharmaceuticals

1. Ranbaxy, Indore
2. Sun Pharma, Baroda
3. Glaxo Smith kline, Chandigarh
4. Ranbaxy, Chandigarh
5. Macleods Pharma, Daman

Shipyard

1. Cochin Shipyard, Cochin
2. Bharti Shipyard, Mumbai
3. Hindustan Shipyard, Vizag.
4. ABG Shipyard, Cochin
5. Goa Shipyard, Vosco Da Gama

Sugar

1. Renuka Sugar, Brazil
2. Daund Sugars, Rohtak
3. Enpro Sugar, Rohtak
4. Mummias Sugar, Kenya
5. Shiraguppe Sugar, Belgaum

Chemical

1. Safe Water Chemicals, Kuwait
2. Hydrogen Plant, Mundra
3. Himedia Lab, Nashik
4. Kalpataru Organics, Sarigam

Textile

1. Well Known, Daman
2. Santham Textile, Silvasa
3. Bhilosa, Silvasa
4. Creative Textile, Balitha
5. Madura Inds, Valsad

IT

1. Cyber City, Hyderabad
2. Cybermotion, Hyderabad
3. Trinity Software Solution, Hyderabad
4. Mahindra Satyam

Malls

1. Patna Malls, Patna
2. Shopper Stop, Bhopal
3. Magarpatta Mall, Pune
4. Shopper Stop, Mumbai

Educational

1. Rajiv Gandhi College, Chandigarh
2. Karpagam Medical College, Coimbatore

Energy

1. Bharat Bijli, Airoli
2. Alstom, Vadodara
3. Cummins, Pune
4. Kirloskar, Saswad

Infrastructure

1. Mumbai Int Airport, Mumbai
2. Cinepolis, Patna
3. Mantri Developers, Bangalore
4. Magarpatta City, Pune

Automobile

1. Mahindra Vehicle, Chakan
2. VE Commercial Vehicle, Pitampur
3. Essar, Mumbai
4. VHCL, Umbergaon

Hotel

1. Hotel Grand Hyatt, Goa
2. Le Meridien, Coimbatore
3. Silver Tower

Government

1. MTRDC, Bhopal
2. PWD, Bhopal
3. BHEL Site Office, Ranchi

Banking

1. ICICI Bank
2. Deutsche Bank, Mumbai
3. Bank of India, Mumbai

Petroleum

1. HPCL, Sugauli
2. Indian Oil Tank, Bhogat
3. JBF Petrochemicals Ltd. Mangalore

Cement Project

1. Sagar Cement, Hyderabad
2. ACC Cement, Vizag
3. Birla Cement, Chittorgarh
4. Aditya Cement, Chittorgarh

Telecom

1. Relaince Communications Mumbai
2. Reliance 4G, Mumbai

Pulp & Paper Mill

1. PT Pindo, Indonesia
2. Subam Papers

Submarine Project

1. VALE Project, Brazil

Metro

1. Hyderabad Metro
2. Bangalore Metro

Beverages

1. Coca Cola, Varanasi
2. Carlsberg, Aurangabad

Electricity Board

1. TNEB Ltd.
2. CSPDCL
3. MPMKVVCL, Bhopal & Gwalior

Industrial

1. Perkins India Pvt. Ltd. Aurangabad.



Products

Window Type Current Transformer

NE R21

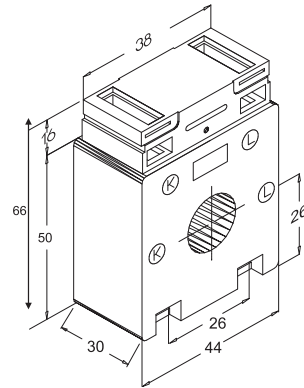
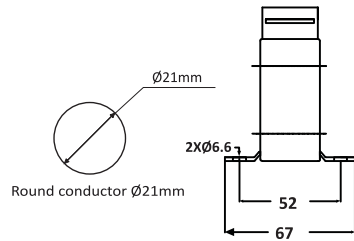

44(L)X66(H)X30(T)

NE R21 Primary Current	Sec - 5A Max. VA		Sec - 1A Max. VA
	Class - 0.5	Class - 1.0	Class - 1.0
75	-	1	-
80	-	1	-
100	-	2.5	2.5
125	-	2.5	2.5
150	-	2.5	5
200	-	3.75	5
250	-	5	-
300	-	5	-

NE MR21

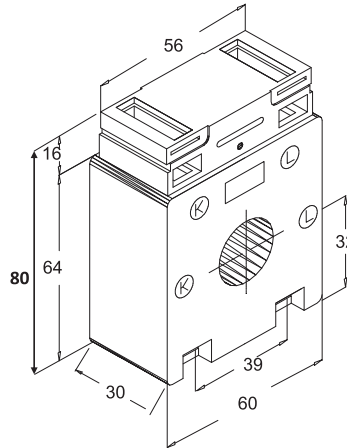
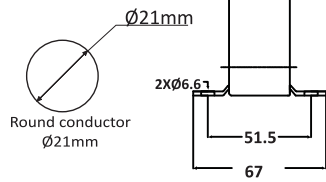

60(L)X80(H)X30(T)

NE MR21 Primary Current	Sec - 5A Max. VA		Sec - 1A Max. VA
	Class - 0.5	Class - 1.0	Class - 1.0
50	-	1	-
60	-	1.25	-
75	-	2.5	-
80	-	3.75	-
100	2.5	5	5
125	2.5	5	5
150	3.75	7.5	7.5
200	5	10	7.5
250	5	10	10
300	7.5	10	10
400	7.5	7.5	-
500	-	10	-

NE 210S

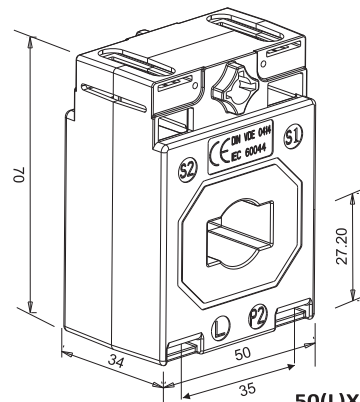
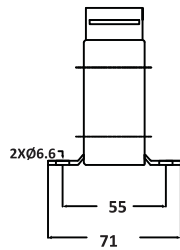

50(L)X70(H)X34(T)

NE210S Primary Current	Sec - 5A Max. VA
	Class 1.0
50	1
60	1.25
75	1.5
100	3.75
120	5
125	5
150	7.5
200	7.5
250	10
300	10

NE 310S

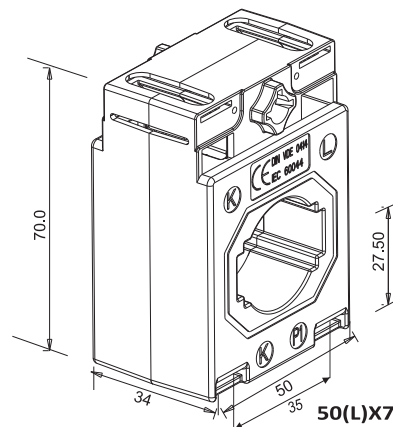
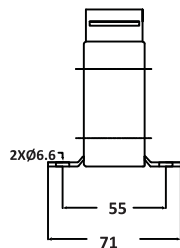

50(L)X70(H)X34(T)

NE310S Primary Current	Sec - 5A Max. VA
	Class 1.0
50	-
60	-
75	-
100	2.5
120	2.5
125	2.5
150	3.75
200	5
250	5
300	5
400	5

All Dimensions are in "mm"

NE 3R30

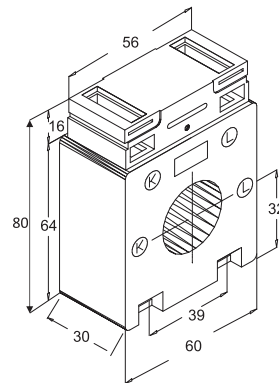
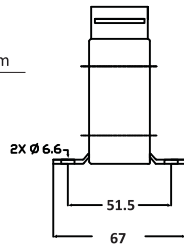
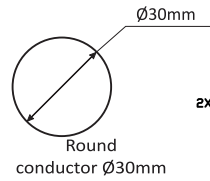

60(L)X80(H)X30(T)

NE 3R30	Sec - 5A		Sec - 1A
	Max. VA		Max. VA
Primary Current	Class- 0.5	Class- 1.0	Class- 1.0
100	-	2.5	2.5
125	-	2.5	2.5
150	2.5	5	5
200	5	7.5	5
250	5	10	10
300	7.5	10	10
400	10	10	10
500	10	10	10
600	-	10	-
700	-	10	-
800	-	10	-

NE 310

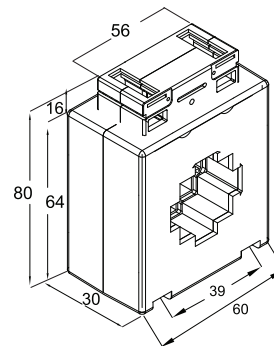
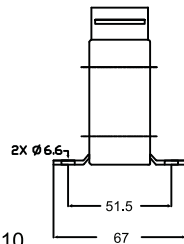
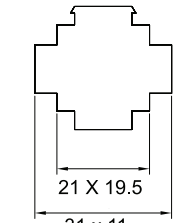

60(L)X80(H)X30(T)

NE 310	Sec - 5A		Sec - 1A
	Max. VA		Max. VA
Primary Current	Class- 0.5	Class- 1.0	Class- 1.0
100	-	2.5	2.5
125	-	2.5	2.5
150	2.5	5	5
200	5	7.5	5
250	5	10	7.5
300	7.5	10	10
400	10	15	10
500	10	15	10
600	-	10	-
630	-	10	-
750	-	10	-
800	-	10	-

NE 4R30

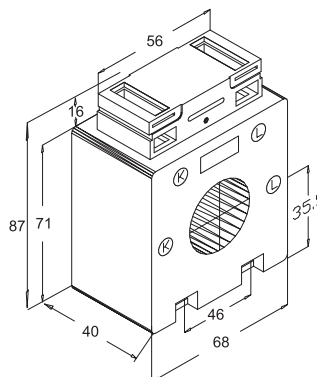
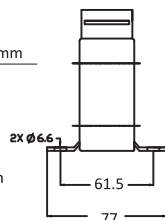
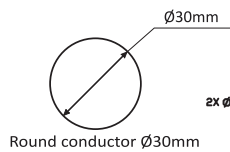

68(L)X87(H)X40(T)

NE 4R30	Sec - 5A		Sec - 1A
	Max. VA		Max. VA
Primary Current	Class- 0.5	Class- 1.0	Class- 1.0
60	-	1.25	-
75	-	2.5	1
80	-	2.5	2.5
100	-	5	5
125	-	5	5
150	-	10	10
200	5	15	10
250	5	15	15
300	10	15	15
400	10	15	15
500	15	15	-
600	15	15	-

NE 4B312

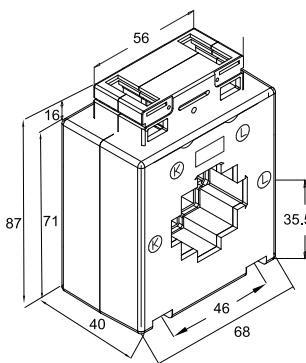
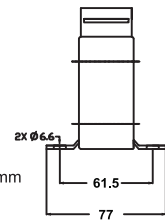
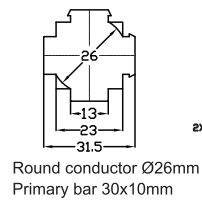

68(L)X87(H)X40(T)

NE 4B312	Sec - 5A		Sec - 1A
	Max. VA		Max. VA
Primary Current	Class- 0.5	Class- 1.0	Class- 1.0
60	-	1.25	-
75	-	1.5	-
80	-	1.5	-
100	-	5	5
125	-	5	5
150	2.5	10	5
200	5	10	10
250	5	15	10
300	10	15	15
400	10	15	15
500	15	15	-
600	15	15	-

All Dimensions are in "mm"



NEM 5R30

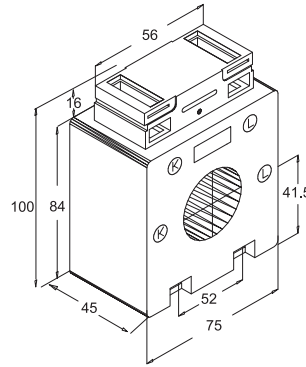
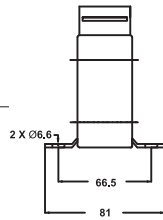
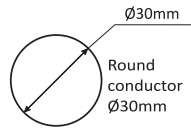

75(L)X100(H)X45(T)

NEM 5R30	Sec - 5A		Sec - 1A
	Max. VA		
Primary Current	Class- 0.5	Class- 1.0	Class- 1.0
50	-	1	-
60	-	1.25	-
75	-	2.5	-
80	-	2.5	-
100	-	7.5	5
125	3.75	10	5
150	5	15	7.5
200	10	15	10
250	10	15	15
300	10	15	15
400	10	15	15
500	10	15	-
600	10	15	-

NEM 5B312

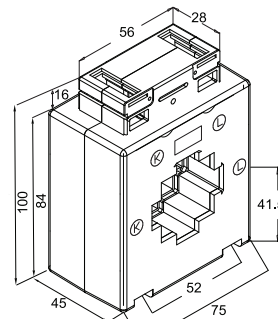
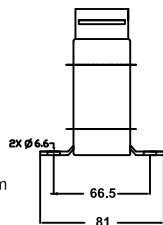
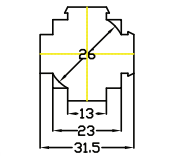

75(L)X100(H)X45(T)

NEM 5B312	Sec - 5A		Sec - 1A
	Max. VA		
Primary Current	Class- 0.5	Class- 1.0	Class- 1.0
50	-	1.25	-
60	-	1.5	-
75	-	2.5	-
80	-	5	-
100	3.75	7.5	3.75
125	5	10	5
150	7.5	15	10
200	10	15	10
250	10	15	15
300	10	15	15
400	10	15	15
500	10	15	15
600	10	15	15

NE 4R 40

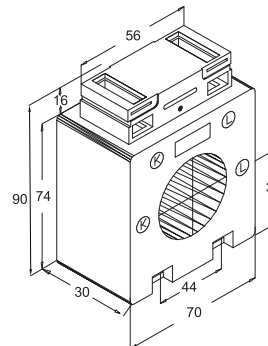
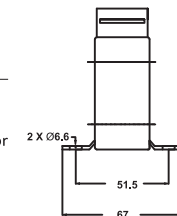
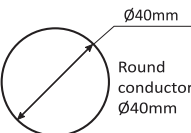

70(L)X90(H)X30(T)

NE 4R40	Sec - 5A		Sec - 1A
	Max. VA		
Primary Current	Class- 0.5	Class- 1.0	Class- 1.0
150	-	1.5	1.5
200	1.5	5	5
250	2.5	7.5	7.5
300	5	7.5	10
400	10	10	10
500	10	10	10
600	-	10	10
630	-	10	-
750	-	10	-
800	-	10	-
1000	-	10	-

NE 412

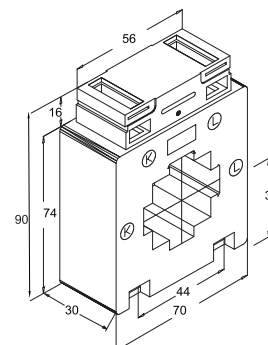
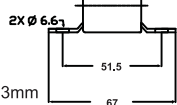
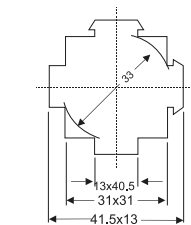

70(L)X90(H)X30(T)

NE 412	Sec - 5A		Sec - 1A
	Max. VA		
Primary Current	Class- 0.5	Class- 1.0	Class- 1.0
150	-	1.5	1.5
200	1.5	5	5
250	2.5	7.5	7.5
300	5	7.5	7.5
400	10	10	10
500	10	10	10
600	-	10	10
630	-	10	-
750	-	10	-
800	-	10	-
1000	-	10	-

All Dimensions are in "mm"



NEM 5B412

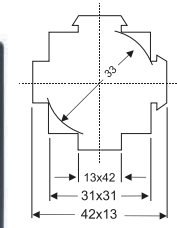

Round conductor Ø33mm
Primary bar 40x13mm
2x30x10mm

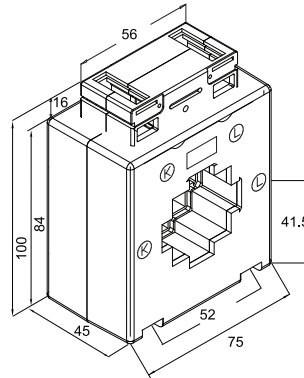
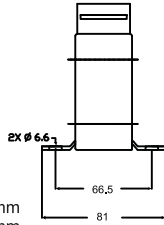

75(L)X100(H)X45(T)

NEM 5B412	Sec - 5A		Sec - 1A
	Max. VA		
Primary Current	Class- 0.5	Class- 1.0	Class- 1.0
75	-	1.5	-
80	-	1.5	-
100	-	3.75	-
125	2.5	5	5
150	5	10	7.5
200	5	15	10
250	10	15	10
300	10	15	15
400	10	15	15
500	10	15	15
600	10	15	15

NE 5R 50

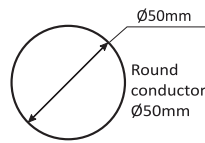

Round conductor Ø50mm

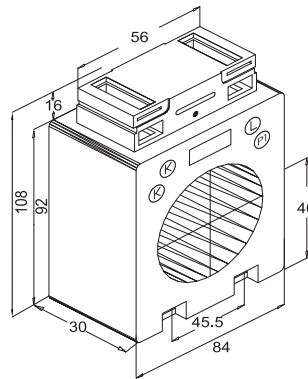
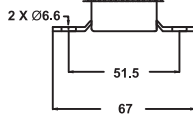

84(L)X108(H)X30(T)

NE 5R50	Sec - 5A		Sec - 1A
	Max. VA		
Primary Current	Class- 0.5	Class- 1.0	Class- 1.0
100	-	1	-
125	-	1.5	-
150	-	2.5	-
200	-	5	5
250	2.5	7.5	5
300	5	10	10
400	10	15	10
500	10	15	15
600	10	15	15
630	15	15	15
750	15	15	15
800	15	15	15
1000	15	15	15
1250	15	15	15
1500	-	15	-

NE 512

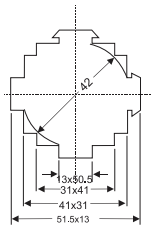

Round conductor Ø42mm
Primary bar 50x13mm
2x40x10mm

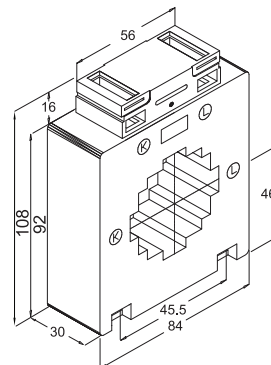
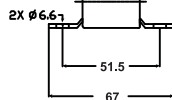

84(L)X108(H)X30(T)

NE 512	Sec - 5A		Sec - 1A
	Max. VA		
Primary Current	Class- 0.5	Class- 1.0	Class- 1.0
100	-	1	1.25
125	-	1.5	2.5
150	-	2.5	2.5
200	-	5	5
250	2.5	7.5	5
300	5	10	10
400	10	15	10
500	10	15	15
600	10	15	15
630	10	15	15
750	15	15	15
800	15	15	15
1000	15	15	15
1250	15	15	-
1500	-	15	-

NE 6R 65

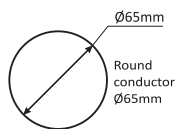

Round conductor Ø65mm

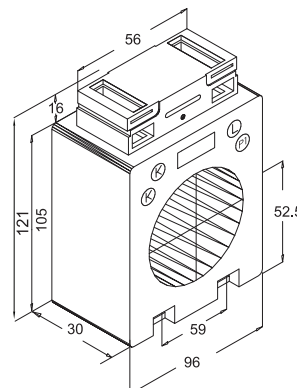
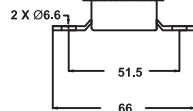

96(L)X121(H)X30(T)

NE 6R65	Sec - 5A		Sec - 1A
	Max. VA		
Primary Current	Class- 0.5	Class- 1.0	Class- 1.0
200	-	2.5	2.5
250	-	5	5
300	5	5	5
400	5	10	7.5
500	10	15	10
600	15	15	15
630	15	15	15
750	15	15	15
800	15	15	15
1000	15	15	15
1250	15	15	15
1500	15	15	15
1600	15	15	15
2000	-	15	-

All Dimensions are in "mm"



NE 615

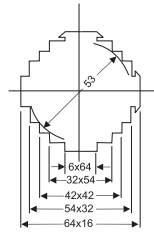

Round conductor \varnothing 53mm
Primary Bar 60X15mm
2X50X10mm
40X40mm

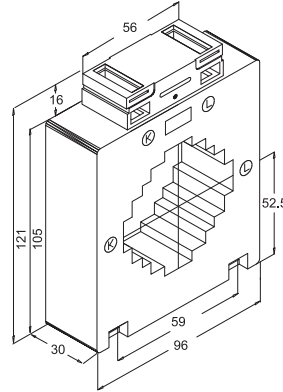
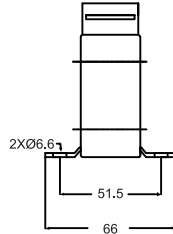

96(L)X121(H)X30(T)

NE 615 Primary Current	Sec - 5A Max. VA		Sec - 1A Max. VA
	Class- 0.5	Class- 1.0	Class- 1.0
200	-	2.5	2.5
250	-	5	5
300	5	5	5
400	5	10	7.5
500	10	15	10
600	15	15	15
630	15	15	15
750	15	15	15
800	15	15	15
1000	15	15	15
1250	15	15	15
1500	15	15	-
1600	15	15	-
2000	-	15	-

NE 640

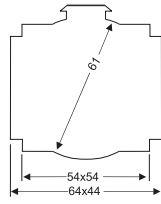

Round conductor \varnothing 61mm
Primary Bar 60X40mm
50X50mm

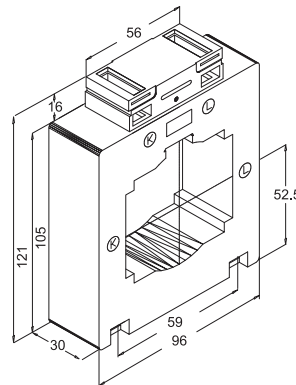
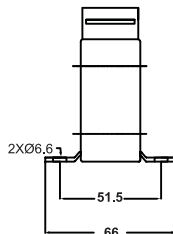

96(L)X121(H)X30(T)

NE 640 Primary Current	Sec - 5A Max. VA		Sec - 1A Max. VA
	Class- 0.5	Class- 1.0	Class- 1.0
200	-	2.5	-
250	-	5	2.5
300	-	5	5
400	3.75	7.5	5
500	5	10	10
600	10	15	15
630	10	15	15
750	10	15	15
800	15	15	15
1000	15	15	15
1250	15	15	-
1500	15	15	-
1600	10	15	-
2000	-	15	-

NE 815

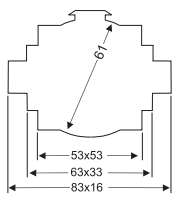

Round Conductor \varnothing 61mm
Primary bar 80X15mm
2X60X10mm
3X50X10mm

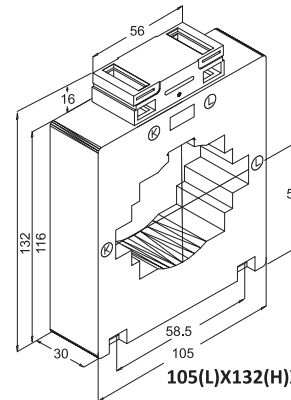
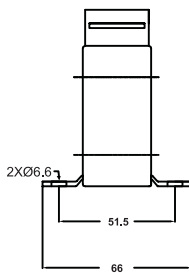

105(L)X132(H)X30(T)

NE 815 Primary Current	Sec - 5A Max. VA		Sec - 1A Max. VA
	Class- 0.5	Class- 1.0	Class- 1.0
400	-	3.75	5
500	-	7.5	7.5
600	5	10	10
630	5	10	10
750	10	10	10
800	10	10	10
1000	15	15	15
1250	15	15	15
1500	15	15	15
1600	15	15	15
2000	-	10	-

NE 830H/NE 830V

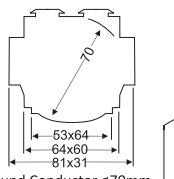

Round Conductor \varnothing 70mm
Primary bar 2X80X10mm
60X60mm

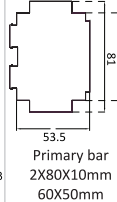
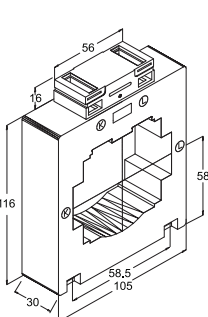

Primary bar
2X80X10mm
60X50mm

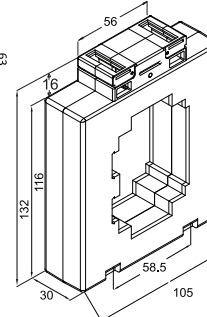

NE 830H

NE 830 V

105(L)X132(H)X30(T)

NE 830H / NE 830V Primary Current	Sec - 5A Max. VA		Sec - 1A Max. VA
	Class- 0.5	Class- 1.0	Class- 1.0
400	-	3.75	3.75
500	-	7.5	7.5
600	5	10	10
630	5	10	10
750	5	10	10
800	7.5	10	10
1000	15	15	-
1250	15	10	-
1500	15	15	-
1600	15	15	-

All Dimensions are in "mm"



NE 1030H/NE 1030V

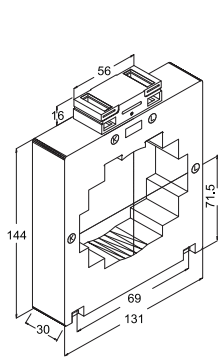
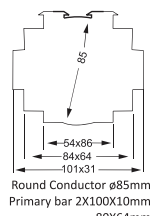

NE 1030H

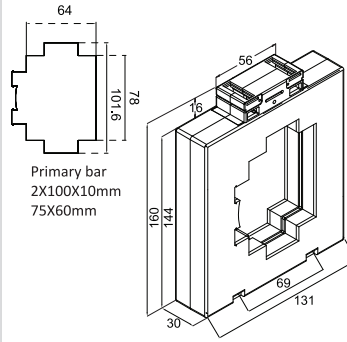

NE 1030 V

131(L)X160(H)X30(T)

NE 1030H/ NE 1030V	Sec - 5A Max. VA		Sec - 1A Max. VA
	Class- 0.5	Class- 1.0	Class- 1.0
600	-	10	7.5
630	-	10	7.5
750	5	10	10
800	7.5	10	10
1000	10	15	10
1250	15	15	10
1500	15	15	10
1600	15	15	15
2000	15	15	15
2500	15	15	15
3000	15	15	-
3200	15	15	-

NE 1056

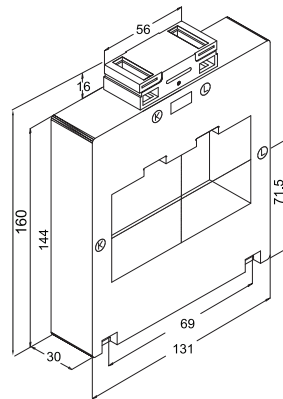
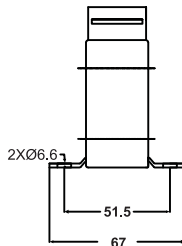
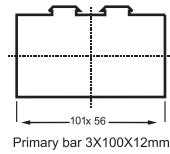

131(L)X160(H)X30(T)

NE 1056	Sec - 5A Max. VA		Sec - 1A Max. VA
	Class- 0.5	Class- 1.0	Class- 1.0
600	-	10	-
630	-	10	-
750	5	10	-
800	7.5	10	-
1000	10	10	10
1250	15	15	15
1500	15	15	15
1600	15	15	15
2000	15	15	-
2500	15	15	-
3000	-	15	-

NE 1256H/NE 1256V

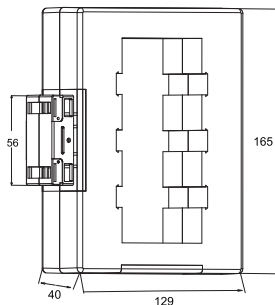
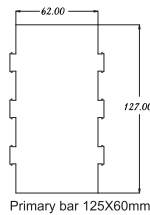

NE 1256H

145(L)X165(H)X40(T)

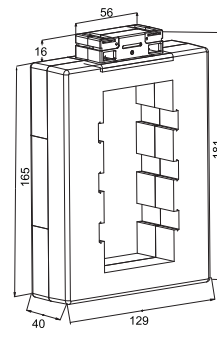

NE 1256V

129(L)X181(H)X40(T)

NE 1256H/ NE 1256V	Sec - 5A Max. VA		Sec - 1A Max. VA
	Class- 0.5	Class- 1.0	Class- 1.0
600	-	10	10
630	-	10	10
750	5	15	15
800	7.5	15	15
1000	15	20	15
1250	15	20	15
1500	15	20	15
1600	15	20	15
2000	15	20	20
2500	15	20	20
3000	15	20	20
3200	15	20	20

NE 1656H/NE 1656V

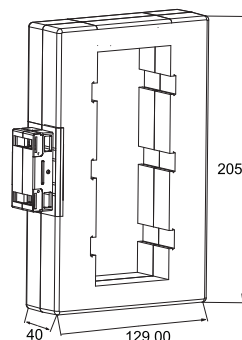
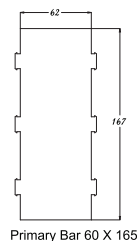

NE 1656H

145(L)X205(H)X40(T)

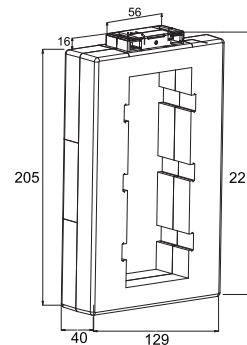

NE 1656V

129(L)X221(H)X40(T)

NE 1656H/ NE 1656V	Sec - 5A Max. VA		Sec - 1A Max. VA
	Class- 0.5	Class- 1.0	Class- 1.0
600	-	10	10
630	-	10	10
750	-	15	15
800	10	15	15
1000	15	15	20
1250	15	15	20
1500	15	15	20
1600	15	15	20
2000	15	20	20
2500	15	20	20
3000	15	20	20
3200	15	20	20
3500	15	20	20
4000	15	20	20
5000	-	20	20

All Dimensions are in "mm"



NE 1659H/ NE 1659V

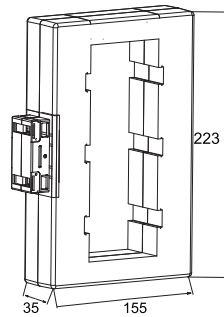
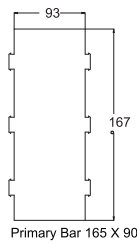

NE 1659H
171(L)X223(H)X35(T)

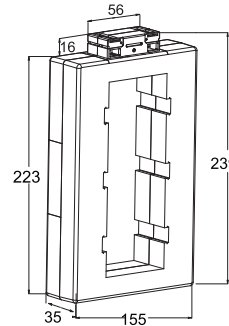

NE 1659V
155(L)X239(H)X35(T)

NE 1659H/ NE 1659V	Sec - 5A		Sec - 1A
	Max. VA		Max. VA
Primary Current	Class-0.5	Class-1.0	Class-1.0
800	-	15	-
1000	15	15	-
1250	15	15	20
1500	15	15	20
1600	15	20	20
2000	15	20	20
2500	15	20	20
3000	15	20	20
3200	15	20	20
3500	15	20	20
4000	15	20	20
5000	15	20	20
6000	15	20	20

NE 2065H/ NE 2065V

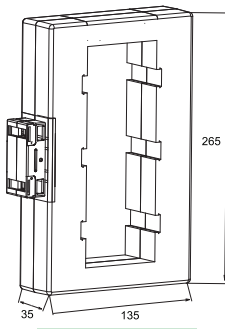
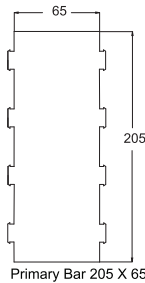

NE 2065H
151(L)X265(H)X35(T)

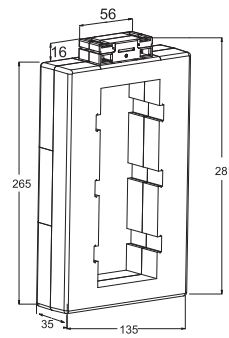

NE 2065V
135(L)X281(H)X35(T)

NE 2065H/ NE 2065V	Sec - 5A		Sec - 1A
	Max. VA		Max. VA
Primary Current	Class-0.5	Class-1.0	Class-1.0
800	-	15	-
1000	15	15	20
1250	15	15	20
1500	15	15	20
1600	15	15	20
2000	15	15	20
2500	15	20	20
3000	15	20	20
3200	15	20	20
4000	15	20	20
5000	15	20	20
6000	15	20	20

Note : Previous model was NE 2007

WOUND PRIMARY CURRENT TRANSFORMERS

NE 3WST/NE 4WST

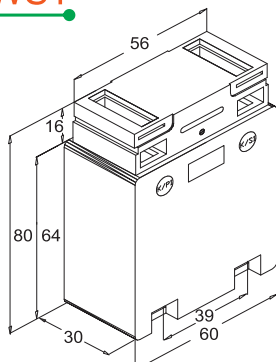

NE 3WST
60(L)X80(H)X30(T)

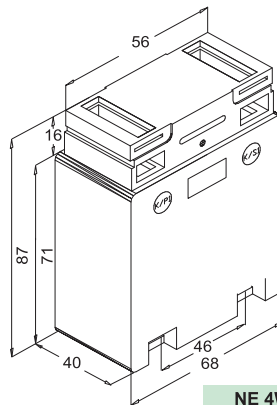

NE 4WST
68(L)X87(H)X40(T)

NE 3WST/ NE 4WST	NE 3WST		NE 4WST	
	Sec - 5A Max. VA	Sec - 1A Max. VA	Sec - 5A Max. VA	Sec - 1A Max. VA
Primary Current	Class-0.5	Class-1.0	Class-0.5	Class-1.0
5	5	5	10	10
6	5	5	10	10
7.5	5	5	10	10
10	5	5	10	10
12.5	5	5	10	10
15	5	5	10	10
20	5	5	10	10
25	5	5	10	10
30	5	5	10	10

NE 4WPL6/ NE M5WPL6

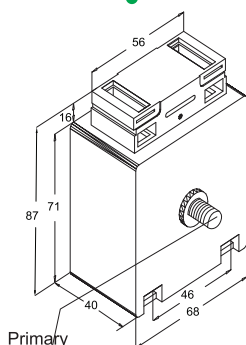

NE 4WPL6
68(L)X87(H)X40(T)

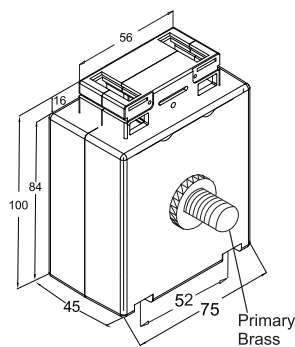

NEM 5WPL6
75(L)X100(H)X45(T)

NE 4WPL6/ NEM5WPL6	NE 4WPL6			NEM5WPL6		
	Sec - 5A Max. VA	Sec - 1A Max. VA	Sec - 1A Max. VA	Sec - 5A Max. VA	Sec - 1A Max. VA	Sec - 1A Max. VA
Primary Current	Class-0.5	Class-1.0	Class-1.0	Class-0.5	Class-1.0	Class-1.0
5	5	5	5	15	15	15
6	5	5	5	15	15	15
7.5	5	5	5	15	15	15
10	5	5	5	15	15	15
12.5	5	5	5	15	15	15
15	5	5	5	15	15	15
20	5	5	5	15	15	15
25	5	5	5	15	15	15
30	5	5	5	15	15	15
40	5	5	5	15	15	15

All Dimensions are in "mm"

NEM 5WPL8/NEM 5WPL10

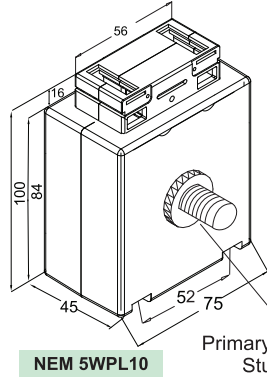
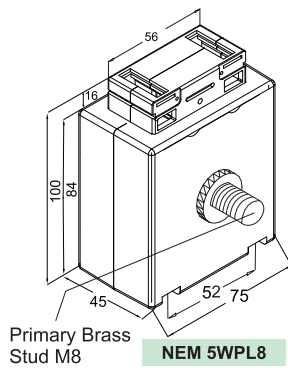

NEM 5WPL8/ NEM 5WPL10	NEM 5WPL8			NEM 5WPL10		
	Sec - 5A Max. VA	Sec - 1A Max. VA	Sec - 1A Max. VA	Sec - 5A Max. VA	Sec - 1A Max. VA	Sec - 1A Max. VA
Primary Current	Class- 0.5	Class- 1.0	Class-1.0	Class- 0.5	Class- 1.0	Class- 1.0
50	15	15	15	-	-	-
60	15	15	15	-	-	-
75	15	15	15	-	-	-
80	15	15	15	15	15	15
100	-	-	-	15	15	15

Primary Brass Stud M8

NEM 5WPL8

NEM 5WPL10

Primary Brass Stud M10

75(L)X100(H)X45(T)

Base Mounting Dimensions Of Remaining Models

NE 830/NE 830V

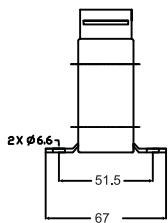

NE 1030/NE 1030V

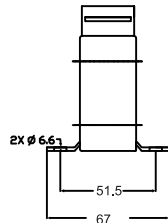

NE 3WST

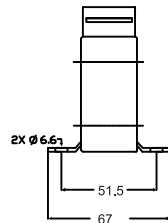

NE 4WST, NE 4WPL6

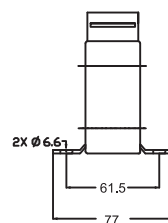

NEM 5WPL6, NEM 5WPL8, NEM 5WPL10

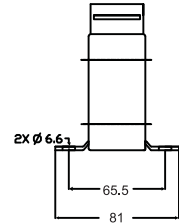

Protection Class CT's in Nylon Casing

NEP 635H

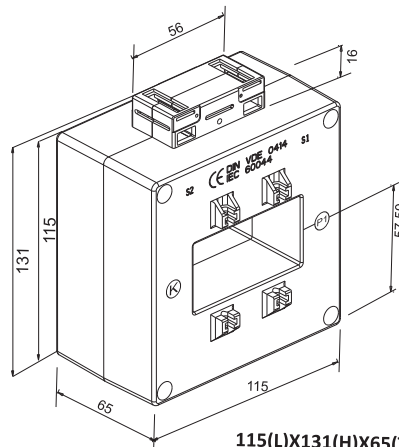
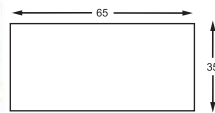
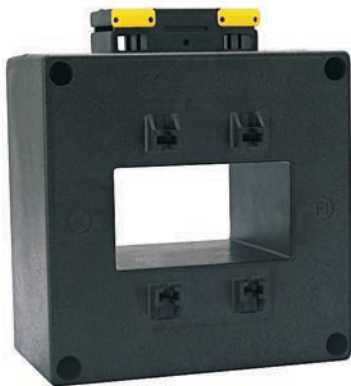

115(L)X131(H)X65(T)

NEP 635H	Sec - 5A Max. VA		
	Class-5P10	Class-5P20	Class-10P20
Primary Current			
300	5	-	5
400	10	5	5
500	10	5	5
600	15	5	5
630	15	5	5
700	15	5	5
750	15	5	5
800	15	5	10
1000	15	5	10
1200	15	10	10
1250	15	10	10
1500	15	10	10
1600	15	10	10
2000	15	-	10

NEP 1257H

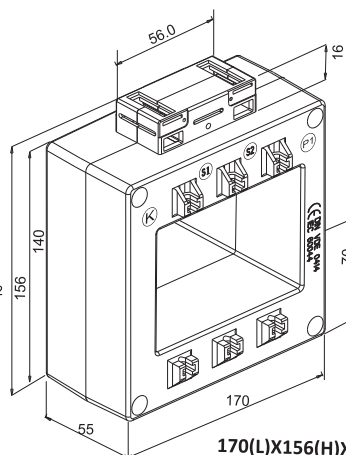
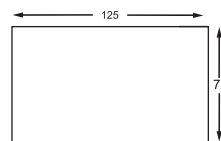

170(L)X156(H)X55(T)

NEP 1257H	Sec - 5A Max. VA			
	Class-5P10	Class-10P10	Class-5P20	Class-10P20
Primary Current				
800	10	10	-	5
1000	15	10	-	5
1200	15	10	5	10
1250	15	10	5	10
1500	15	10	5	10
1600	15	10	5	10
2000	15	10	-	10
2500	15	10	-	10
3000	15	10	-	10
3200	15	10	-	10
3500	15	15	-	-
4000	15	15	-	-

All Dimensions are in "mm"



Voltage & Control Transformers

Single Phase Tape Insulated/Resin Cast Control/ Voltage Transformer.

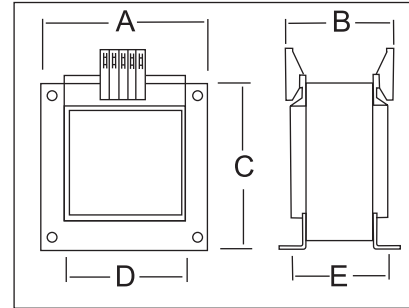

Rating as per customer requirement						
Overall Dimensions (Approx.)						
Rating in VA	A (mm)	B (mm)	C (mm)	D (mm)	E (mm)	Appx. wt. in kgs.
50	100	100	95	64	73	3
100	100	100	95	64	73	3.3
200	118	105	110	76	76	4.7
250	118	115	110	76	76	5.2
500	157	110	140	100	78	8.5
750	157	120	140	100	85	10.5
1000	190	135	190	132	78	12.5
1500	190	145	190	132	85	16.5
2000	225	150	200	157	115	25
2500	245	155	220	167	120	30
3000	250	165	225	175	123	33.5
4000	275	180	245	187	130	42.5
5000	280	190	255	198	135	48.5

Three Phase Tape Insulated/Resin Cast Control/ Voltage Transformer.

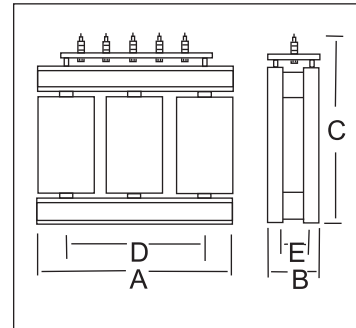
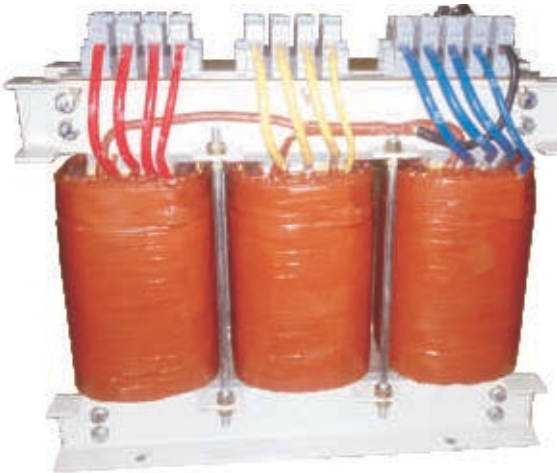

Rating as per customer requirement						
overall dimension approx) three phase						
Rating in VA	A (mm)	B (mm)	C (mm)	D (mm)	E (mm)	Appx. wt. in kgs.
500	485	110	165	340	51	25
750	485	120	165	340	58	31.5
1000	585	135	215	395	51	37.5
1500	585	145	215	395	58	50
2000	690	150	235	465	75	75
2500	750	155	255	505	80	90
3000	765	165	260	515	85	100
4000	840	180	280	565	90	127
5000	855	190	280	575	95	145

All Dimensions are in "mm"

Note: Voltage & Control Transformers can be made available from 50VA to 5000VA burden, both in single phase & three phase systems as per customers demand.

NEWTEK CTs :

Increased Safety -

The joining point where the two halves of the housing meet inside the primary bar opening is crucial to safety. Quite in accordance with NEWTEK's motto – safety is built into our products – the two halves of the housing are not aligned with a butt joint, instead they are made to overlap in the new NE series. Insulated Protective Caps For Primary Fixing Bolts – To protect against unintentional contact the bolts of the primary fixing devices can be covered by protective insulation caps.

The NEWTEK Secondary Terminals –

In this clamping system pressure is transmitted by means of a nut (Pad) to the ends of the conductor (Lift principle). The conductor is therefore loaded only under pressure and cannot be damaged by rotating components. Thanks to our clamping system the ends of the conductors are clamped over a wide area which ensures lower contact resistance. Pressure forces of several hundred Newton's are reached. In these way conductors even with multiple, fine and extremely fine wires are so well compressed that no harmful gases can penetrate to cause corrosion. It therefore provides an extremely long lasting connection even in aggressive industrial environment. The plus – minus slot of the M5 (0.5mm) screws allows ease in handling. At the NE series both, screws and nuts are designed in such a way to prevent unintentional loosening.

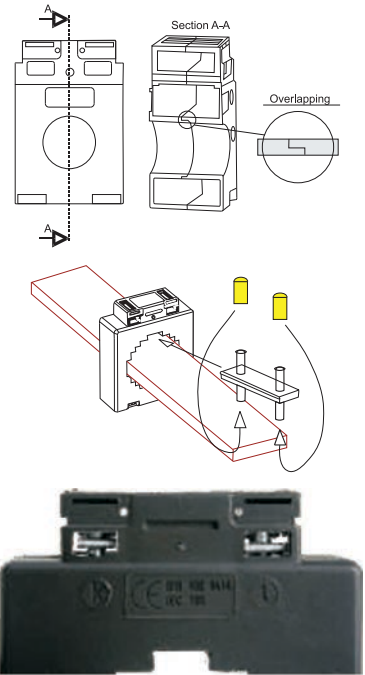

Mounting Arrangement of Newtek CTs



Secondary Terminal Covers



Base Mounting Clamp



Bus Bar Mounting Clamp



Din Rail Mounting Clamp

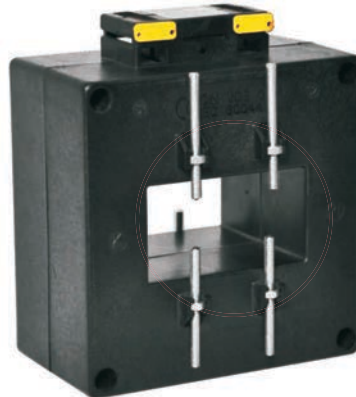

Bus Bar Mounting for Protection CTs



Bus Bar Mounting for Low Burden CTs



General Features of NEWTEK Current Transformers

Electrical Features

Rated frequency = 50-60 Hz
 Class of insulation = E
 Rated short time thermal current $I_{th} = 60 I_n$
 Nominal surge current $I_{dyn} = 2.5 I_{th}$
 (Minimum 100 kA at all window type CT's)
 Highest voltage for equipment $U_m = 0.72 kV$
 (Other voltages on request)
 Rated power-frequency withstand voltage = 4kV/ 1min
 (Other voltages on request) Instrument security factor = FS5 or FS10

Mechanical Features

Unbreakable, flame retardant, self-extinguishing
 Nylon casing of grade UL 94 V2.
 Cores are made from high grade CRGO material.
 Dual coated copper wire having class of insulation H.
 Nickel plated secondary terminals with
 plus minus screws of 0.5Nm.
 Integrated secondary terminal caps.

Special Notes

CT's also available in 0.5S, 0.2 and 0.2S accuracy class on request.
 Other VA's are as per customer requirement.

Applicable Standards:

Current Transformer: IS: 2705/1992; IEC/EN: 60044-1
 Potential Transformer: IS: 3156/1992; IEC: 60044-2
 Control Transformer: IS: 12021/1987; IEC: 60044-2

Control & Potential Transformer:

Newtek provides tailor made range of LT Potential & Control Transformer as per customers demand both in single phase & three phase systems, in Resin Cast/Tape Insulated/Varnish Impregnated type of Insulation.
 Voltage range 0 to 690V, Max VA:-10kVA. We can supply dual secondary, tap changer type PTs & Control Transformers.
 Available Class of PTs: 0.2,0.5,1.0,3P,6P We can provide you IVTs, RVTs on demand.

Accessories:



Base Clamp



Shrouding Cap for Resin Cast CTs



Bus Bar Lock for NE210S & NE310S Model



Dinrail Clamp



Base Clamp for Resin Cast CTs



Bus Bar Clamp



Shrouding Cap for WPL CTs

Newtek Resin Cast CT's

Newtek Electricals also innate the expertise in design and manufacturing of conventional resin cast CT's. as well as protection class CT's. VIZ, 5P5, 5P10, 5P20 & PS Class CT's.





NEWTEK ELECTRICALS
HERTZ INSTRUMENTS PVT. LTD.

M-90 M.I.D.C. Waluj, Aurangabad – 431136 Maharashtra, India. Tel/Fax : +91-0240 2551555 Mobile : 9370062635, 9372862635
Email : newtekelectricals@gmail.com, mkt.newtek@gmail.com Website : www.newtekelectricals.com